

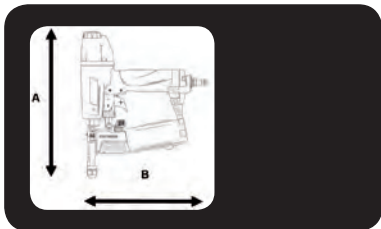

Paslode®





PSN100.1

		<p> A = 380 mm B = 500 mm C = 130 mm </p> <p> = 3,9 kg </p>
--	--	---

<p>Min. 5 bar</p> <p>Max. 8 bar</p>	<p>EN 12549+EN ISO 4871</p>	<p> L WA.1s = 98,1 dBA L pA.1s = 90,5 dBA L pA.1s1m = 85,1 dBA </p>
<p>2,7 l (8 bar) /</p>	<p>EN 12096 : 2017</p> <p>ISO 8662-11</p>	<p>Vibration = 3,5 m/s²</p>
<p>Ps max. = 8 bar</p>		

<p>PASLODE 34° STRIP NAILS</p>	<p>Max. 90x</p>	<p> d= 2,8 - 3,4mm L= 50 - 100 mm </p>















+



=



	Sequential trigger actuation/ Einzelauslösung/ enkelschots/ Déclenchement du tir - mode séquentiel/ Funcionamiento secuencial "en continuo"/ Gatilho de actuação sequencial/ funzionamento sequenziale (colpo a colpo)/ Enkeltskuds aftrækker/ Enkelskott/ Enkeltskudds avtrekker/ Kertalaukaisu/ Üksiklasu meetodil töötamine/ Uruchomienie spustu sekwencyjne/ Sekvenční spoušť/ Egyes lövés (szakaszosan működtetett elsütő billentyűvel)/ Posamezno proženje/ Kontaktirajte singl / Последовательная активация при нажатии на курок/ Sekvenčná aktivácia spúšte/ التشغيل بالزئ التسلسلي المقيد / Nuoseklusis paleidimo mechanizmas/ Sekvenciālās palaišanas iedarbināšana / Raðkveikjuvirkjun
	Contact trigger actuation/ Kontaktauslösung/ repeterend schieten/ Déclenchement du tir - mode rafale/ Funcionamiento por contacto "clavo a clavo"/ Gatilho de actuação por contacto/ funzionamento a contatto/ Stødskydnings aftrækker/ Støtskjutning/ Støtspikrings avtrekker/ Kosketuslaukaisu/ Automaatmeetodil töötamine/ Uruchomienie spustu przez kontakt/ Kontaktní spoušť/ Sorozatlövés (folyamatosan behúzott elsütő billentyűvel)/ Kontaktno proženje/ Kontaktirajte pokretanje/ Контактная активация при нажатии на курок/ Kontaktná aktivácia spúšte/ التشغيل بتلامس الزئ / Kontaktinis paleidimo mechanizmas/ Kontakta palaišanas iedarbināšana/ Snertikveikjuvirkjun

Model: PSN100.1 No. 502900 	Model: PSN100.1 No. 574686 			
				
				
				
No. 014748 + No. 574500		No. 014121		

Accessories

			
No. 151299	No. 576216	No. 501022	No. 500903
0,5 l oil	1 l oil		

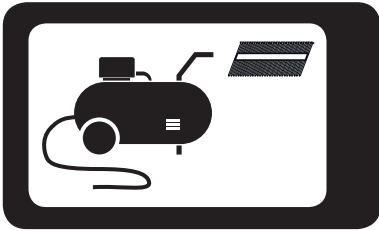

014748

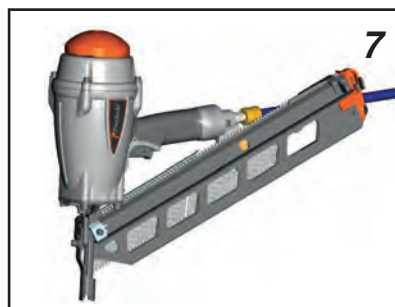
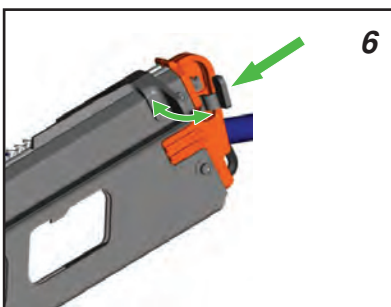
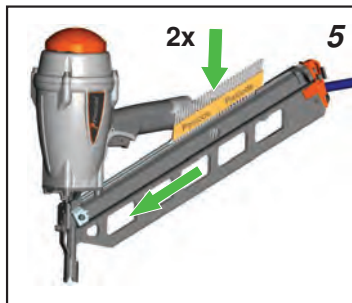
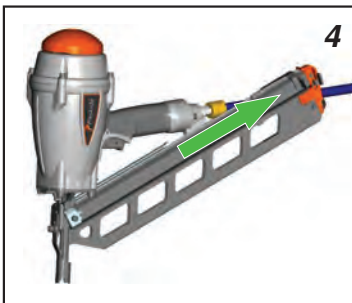
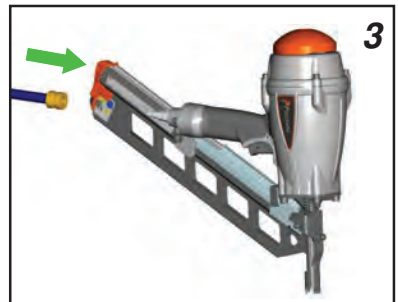
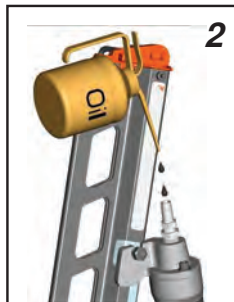
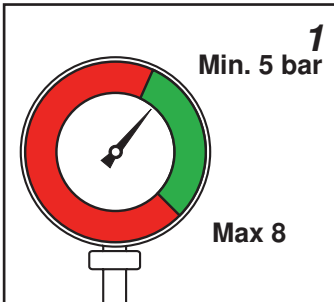



014748

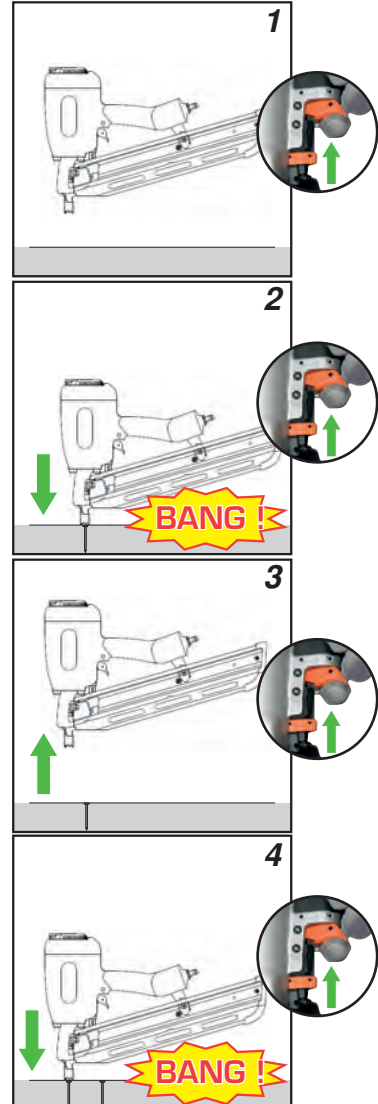
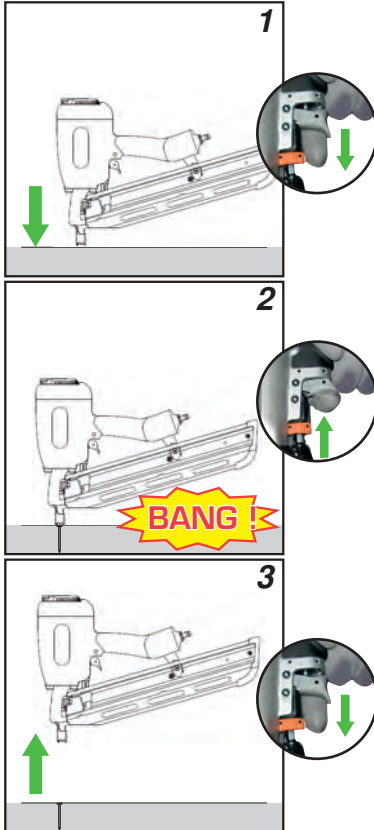

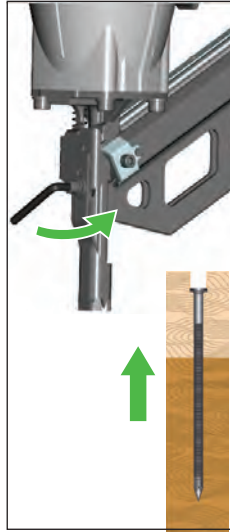
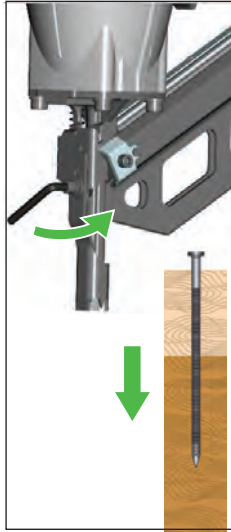
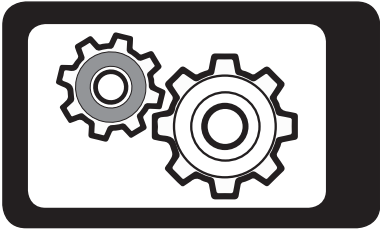

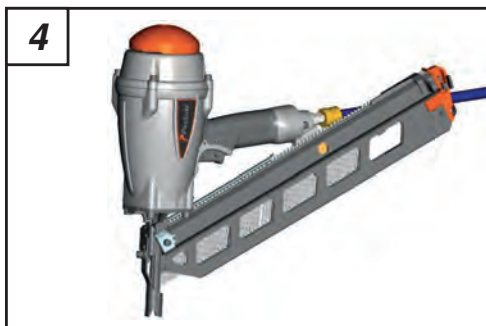
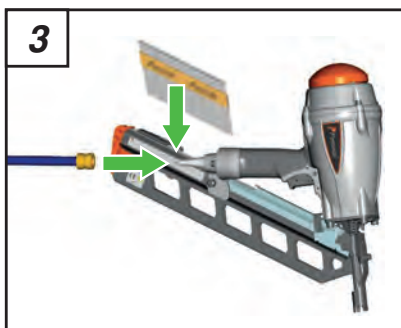
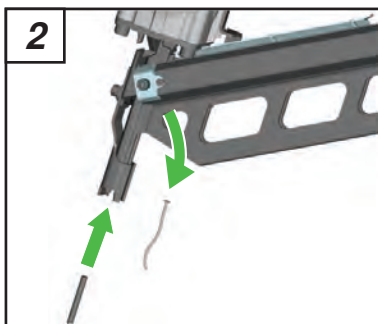
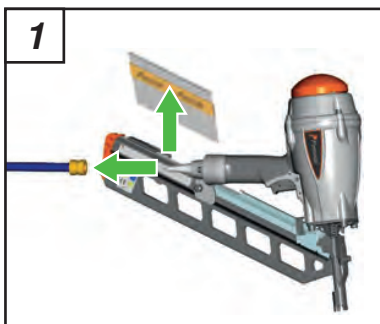

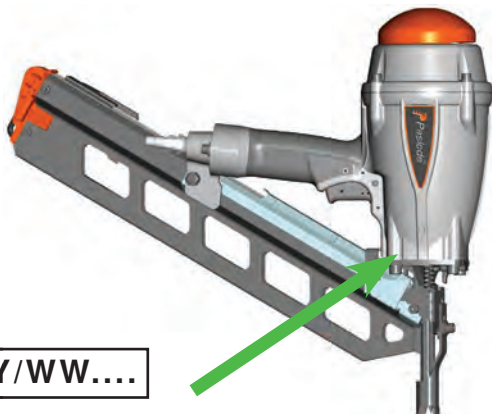

YY/WW....

YY= Year of manufacture
WW = Week of manufacture

**Resting position/ Ruheposition/ Position de repos/ Ruststand/
Posición de descanso/ Posizione di riposo/ Posição de des-
canso/ Pozycja spoczynku/ Klidová poloha/ Nyugalmi állapot/
Положение в нерабочем состоянии/ Θέση αδράνειας/ Hviles-
tilling/ Viloläge/ Hvileposisjon/ Lepoasento/ Položaj mirovanja/
Pokožová poloha/ Položaj mirovanja/ وضع السكون / Ramybės
padėtis/ Ooteasend/ Miera stāvoklis/ Hvíldarstaða**





ITW CONSTRUCTION PRODUCTS EUROPE
Code 574500 (05/2019)
www.spitpaslode.com