



CNP65.2

Coil Nailer



www.paslode.org



NEVER STOP BUILDING

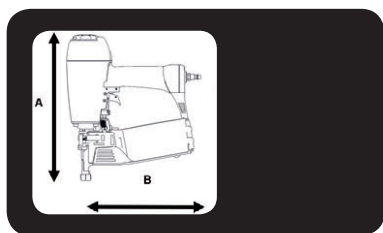

| | | |
|--|--|--|
| | | <p> A = 320 mm B = 310 mm C = 148 mm </p> <p> = 2,38 kg </p> |
|--|--|--|

| | |
|--|---|
| | <p>1,77l (6 bar) /</p> <p>Ps max. = 8,3 bar</p> |
|--|---|

| | |
|-----------------------------|---|
| <p>EN 12549+EN ISO 4871</p> | <p> L WA.1s = 102 dBA L pA.1s = 97 dBA L pA.1s1m = 89 dBA </p> |
| <p>EN12096 : 1997</p> | <p>Vibration = 3,5 m/s²</p> |

| | | |
|-------------------------------------|-------------------------------|---|
| <p>325 x</p> | | |
| <p>Paslode 0° Coil Nails</p> | <p>Paslode IN-tape</p> | <p> D max. = 5,8 mm L = 27-65 mm d = 2,1-3,0 mm </p> |





+



=



| | |
|---|--|
|  | <p>Sequential trigger actuation/ Einzelauslösung/ enkelschots/ Déclenchement du tir - mode séquentiel/ Funcionamiento secuencial "en continuo"/ Gatilho de actuação sequencial/ funcionamiento secuencial (colpo a colpo)/ Enkeltskuds aftrækker/ Enkeltskott/ Enkeltskudds avtrekker/ Kertalaukaisu/ Üksiklasu meetodil töötamine/ Uruchomienie spustu sekwencyjne/ Sekvenční spoušť/ Egyes lövés (szakaszosan működtetett elsütő billentyűvel)/ Posamezno proženje/ Kontaktirajte singl / Последовательная активация при нажатии на курок/ Sekvenčná aktivácia spúšte/ التشغيل بالزر التسلسلي المقيد / Nuoseklusis paleidimo mechanizmas/ Sekvenciālās palaides iedarbināšana Račkovjeivirkjūn</p> |
|  | <p>Contact trigger actuation/ Kontaktauslösung/ repeterend schieten/ Déclenchement du tir - mode rafale/ Funcionamiento por contacto "clavo a clavo"/ Gatilho de actuação por contacto/ funzionamento a contatto/ Stødskydnings aftrækker/ Støtskjutning/ Støtspikrings avtrekker/ Kosketuslaukaisu/ Automaattimetodil töötamine/ Uruchomienie spustu przez kontakt/ Kontaktní spoušť/ Sorozatlövés (folyamatosan behúzott elsütő billentyűvel)/ Kontaktno proženje/ Kontaktirajte pokretanje/ Контактная активация при нажатии на курок/ Kontaktná aktivácia spúšte/ التشغيل بتلامس الزر / Kontaktinis paleidimo mechanizmas/ Kontakta palaides iedarbināšana/ Snertikveivirkjūn</p> |

Model: CNP65.2
No. 650442



No. 014748 + No. 577327

Accessories

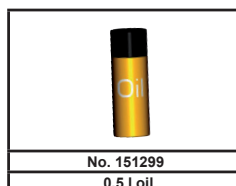

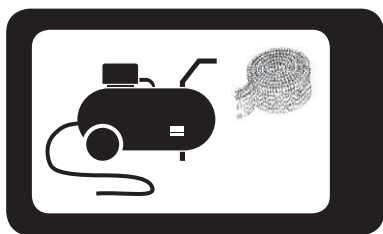

014 748

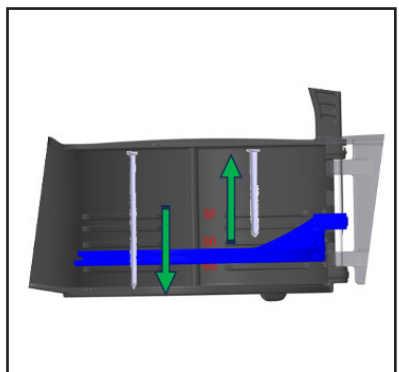
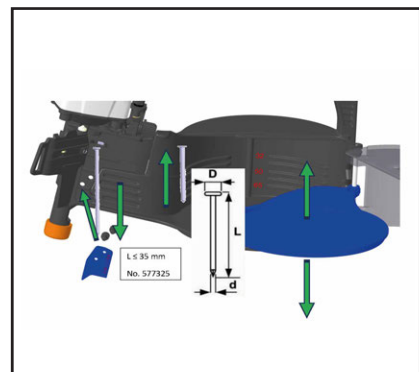
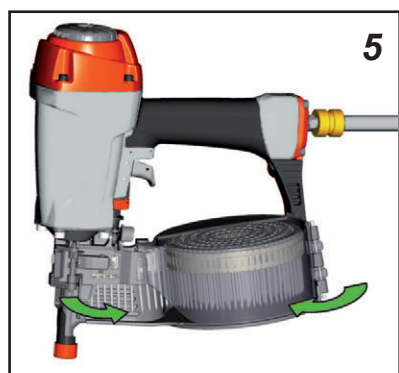
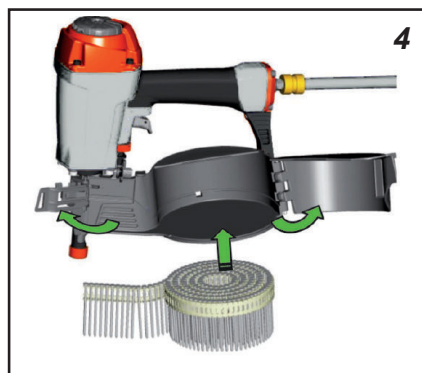
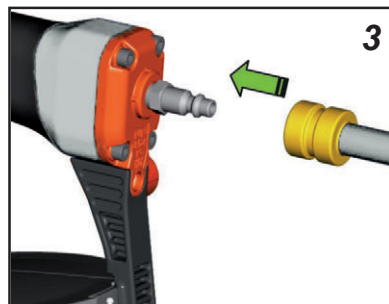
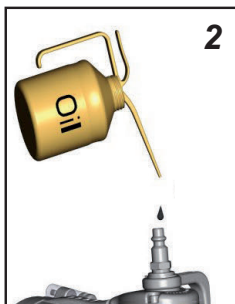
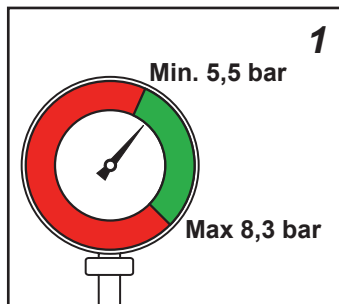



014 748

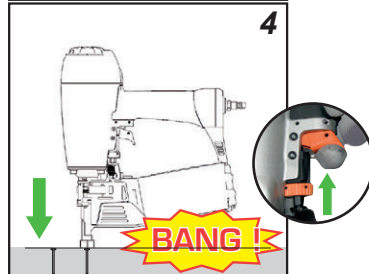
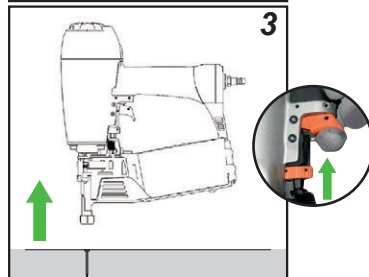
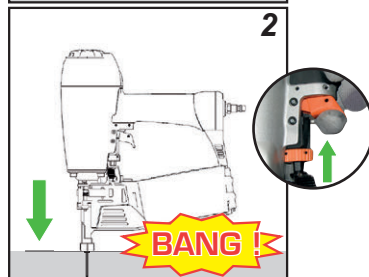
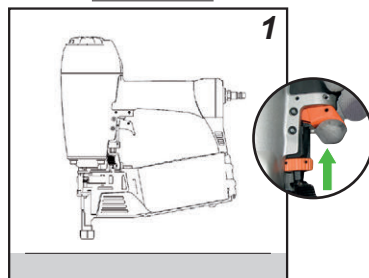
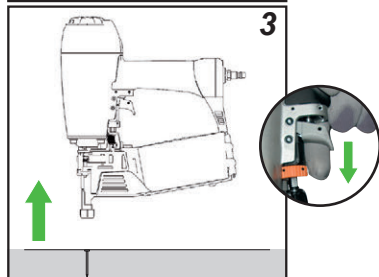
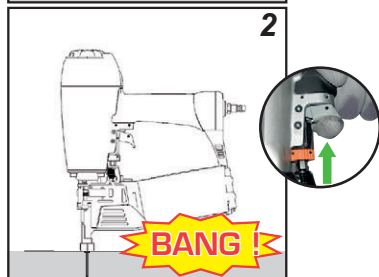
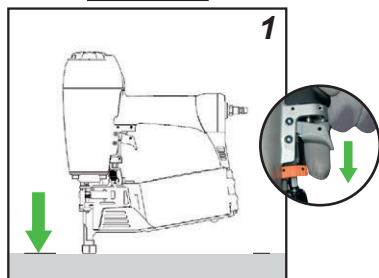

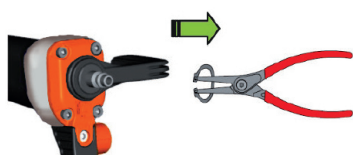
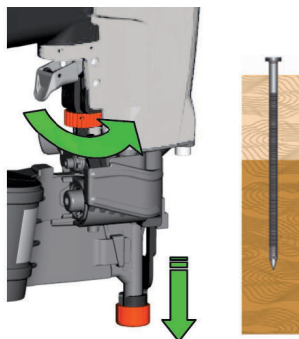
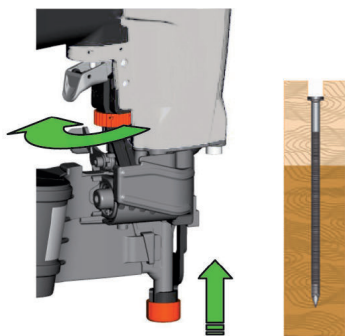
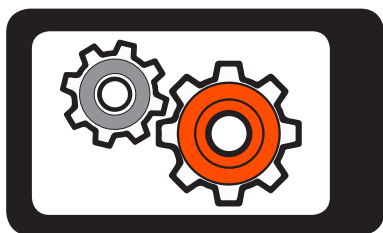

Resting position/ Ruheposition/ Position de repos/ Ruststand/ Posición de descanso/ Posizione di riposo/ Posição de des-canso/ Pozycja spoczynku/ Klidová poloha/ Nyugalmi állapot/ Положение в нерабочем состоянии/ Θέση αδράνειας/ Hviles-tilling/ Viloläge/ Hvileposisjon/ Leposento/ Položaj mirovanja/ Pokojová poloha/ Položaj mirovanja/ وضع السكون/ Ramybės padėtis/ Ooteasend/ Miera stāvoklis/ Hvíldarstaða

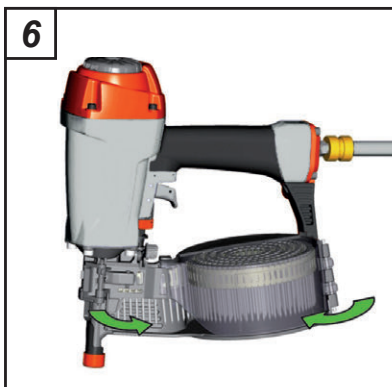
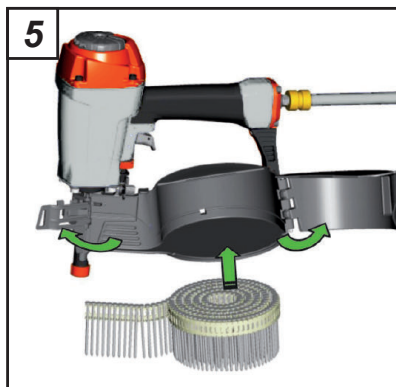
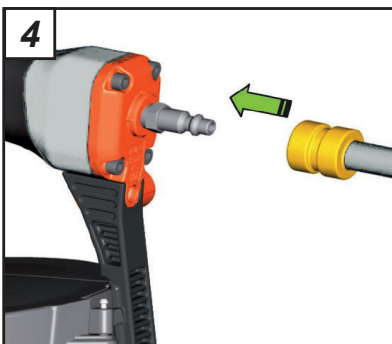
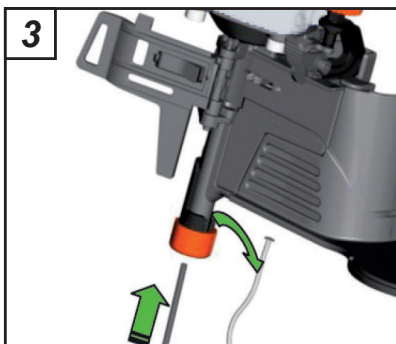
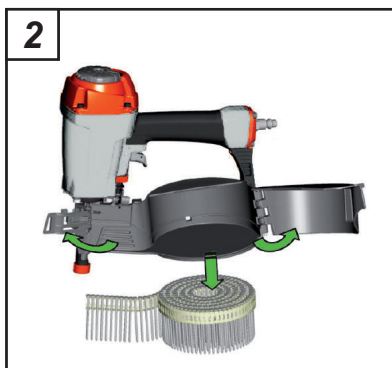
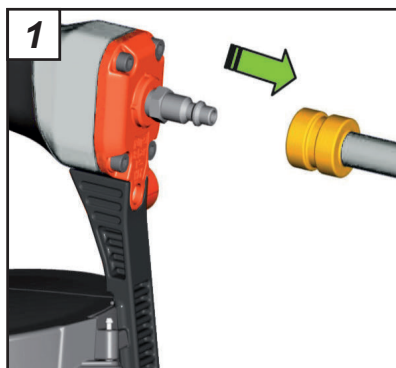
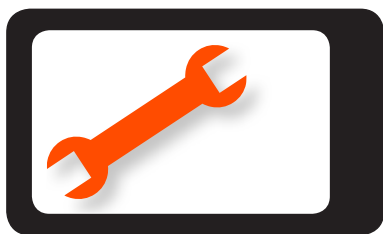



ITW Befestigungssysteme GmbH
Carl-Zeiss-Str. 19
30966 Hemmingen, Germany

ITWCP UK Glenrothes
Fife UK KY6 2SW

CODE: 557327 (07/2024)